

# ARCHITECTURAL WALKING TOUR

Recent additions and renovations to the Bennington College campus.

Named one of "ten college campuses with the best architecture" by Architectural Digest, Bennington's deep commitment to the aesthetic of the physical surrounding is reflected in every structure on campus. This guide offers architectural highlights from the Bennington campus—buildings lovingly restored and newly constructed over the last decade.

## 1 CRICKET HILL

**Renovated 2002**  
New home of the Admissions Office, Cricket Hill was part of the original Jennings estate. It was completely refurbished inside and out in 2002.



## 4 DICKINSON SCIENCE BUILDING

**Renovated 2013**  
Interior building work included elevator, railings, and fire alarm system. The construction of a new computer lab and lab upgrades are in progress, including a new neuroscience lab.



## 6 BIOMASS PLANT

**Built 2008**  
**Centerline Architects and Planners**  
*Winner of Excellence in Architecture Award 2009*  
*The American Institute of Architects/Vermont*

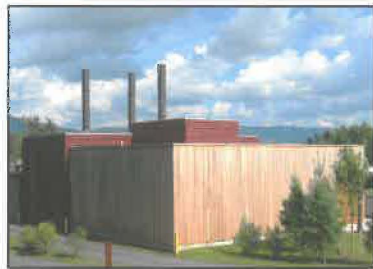

This 5,200-square-foot addition to the campus utility plant houses a 400hp wood-chip, or "biomass," boiler that serves as the College's primary heating source. The wood chips are a byproduct of forest management, which make them an excellent and locally abundant option as a source of renewable energy for the College.

## 8 DEANE CARRIAGE BARN

**Renovated 2007**  
Careful restoration has brought this historic performance space into the 21st century while preserving its distinctive look. With a remodeled music workshop, cherry floors, the addition of a vestibule, entryway, and elevator for maximum accessibility, Deane Carriage Barn provides a handsome space for students, faculty members, and visiting artists to share their work. *Named in honor of Barbara Ushkow Deane '51.*



## 10 VISUAL AND PERFORMING ARTS CENTER

**Renovated 2010-11**  
Upgrades to VAPA's classrooms, performance, and work spaces have improved functionality, energy efficiency, and air quality. An entirely new lighting system has been implemented in Usdan Gallery for optimal viewing of artwork exhibitions. New energy efficient windows will improve VAPA's carbon footprint. The VAPA North project has turned the area behind the building into a utilitarian and beautiful transition to the new CAPA buildings.



## 11 CENTER FOR THE ADVANCEMENT OF PUBLIC ACTION

**Tod Williams and Billie Tsien, Architects**  
*Winner of the American Institute of Architects' 2013 Architecture Firm Award*  
The Center for the Advancement of Public Action (CAPA) is a complex of three, geothermally heated buildings, each clad in reclaimed Vermont marble, totaling 15,000 square feet. The \$20-million facility houses classrooms, seminar and conference spaces, lounges, kitchen facilities, and suite-style living accommodations for visiting lecturers and fellows.



## 13 EAST ACADEMIC CENTER

**Renovated 2010**  
The East Academic Center, which most recently housed a center for pre-Kindergarten students, opened this September. Two mediated classrooms open onto deep porches, and three student lounges are available for relaxing or quiet study.



## 14 COMMONS DINING HALL

**Renovated 2013**  
The center of food services, the Dining Hall received an extensive renovation in the servery, entrance, salad bar, and new equipment.



## 15 STUDENT CENTER

**Built 2007 Taylor & Burns Architects**  
*Winner of Excellence in Architecture for a New Building 2010 Society for College and University Planning*  
This 10,000-square-foot structure encompasses a snack bar and café, a performance space with state-of-art sound and lighting systems, and a lounge for small and large student gatherings. Its floor-to-ceiling windows open to a terrace on nice days and turn the building into a beacon at night.



## 19 DAVIS ALUMNI HOUSE

**Renovated 2004**  
Nestled in the southwestern corner of campus, the Davis alumni house welcomes all visitors to campus with six elegantly furnished rooms and its bookcase of alumni works. With new furnishings, an updated kitchen and bathrooms, the Alumni House is the ideal retreat for all visiting alumni and friends. *Named in honor of Virginia Todahl Davis '40.*



## 20 FACULTY HOUSES

**Renovated 2005, 2006, and 2008**  
Two houses on Faculty Row were renovated in 2005 and 2006, and several in the Orchard were restored since 2008.



## 23 24 31 33 34 COLONIAL HOUSES

**Renovated 2005, 2006, 2009, exteriors renovated in 2011 and 2012**  
Part of the original residential campus designed by J.W. Ames and E.S. Dodge, these Colonial-style houses frame



the College's central Commons Lawn. Houses features numerous Colonial Revival details, including pilasters, quoining, and transoms on the portico. All of the renovations were carefully managed to preserve the historic character of the house.

## 35 36 37 BARNES HOUSES

**Renovated in 2008 and 2009, exteriors renovated in 2011, 2012**  
The geometric forms of these student houses are typical of the designs of Edward Larrabee Barnes, who also designed the Walker Art Center, in Minneapolis, MN, and the IBM building in Manhattan.



## 38 39 40 PERKINS, MERCK, AND PARIS-BORDEN HOUSES

**Built 2000 • Kyu Sung Woo**  
*Featured in Architectural Record magazine*  
Three stories with stunning east-facing views, airy kitchens, and sun-filled common rooms, these houses marry traditional materials like cedar siding and stone walls with contemporary design. *Named in honor of Penelope Perkins Wilson '45, Katharine Evarts Merck '46, and Susan Paris Borden '69.*



## FACILITIES AND LANDSCAPING MASTER PLAN

**Completed 2004**  
**Kyu Sung Woo and Reed Hildebrand**  
The Facilities and Landscaping Master Plan has guided plans for campus expansion, a network of footpaths and roadways, a lighting system, and ongoing landscaping, plantings, and pruning. To clearly link and label the various buildings and venues of the campus, a uniform signage system was created in 2005. The signs are a contemporary statement in Cor-ten, which oxidize to a beautiful, autumnal red-brown, and reflective, stainless steel.





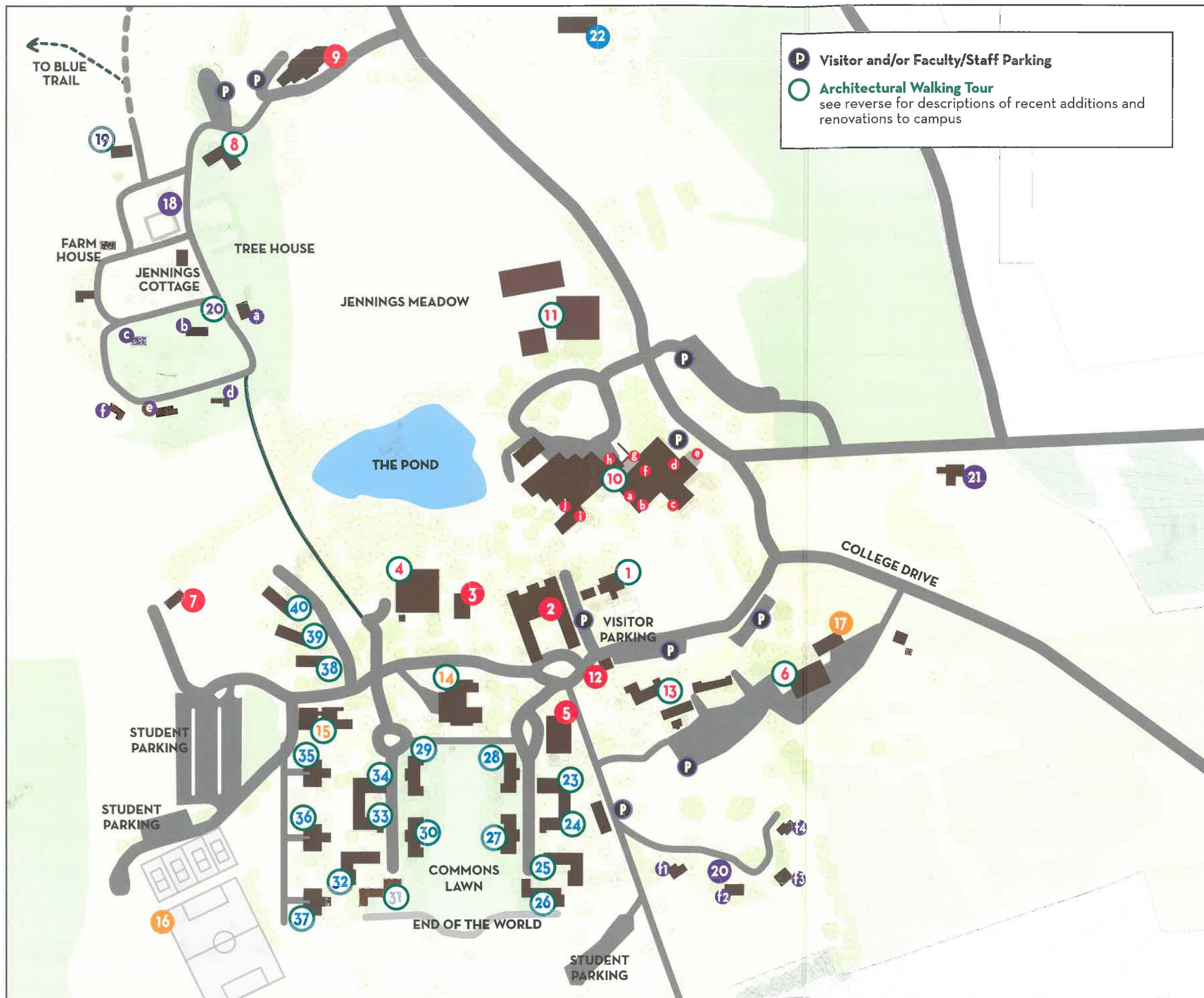

### Academic/Administrative

- 1 Cricket Hill/Admissions Office
- 2 The Barn/Administrative Offices
- 3 Tishman Lecture Hall
- 4 Dickinson Science Building
- 5 Crossett Library
- 6 Penny Wilson '45 Buildings and Grounds
- 7 Stickney Observatory
- 8 Deane Carriage Barn
- 9 Jennings Music Building
- 10 Visual and Performing Arts Center (VAPA)
  - a Margot Tenney Theater
  - b Lester Martin Theater
  - c Greenwall Auditorium
  - d Martha Hill Dance Theater
  - e Petrie Terrace
  - f Newman Court
  - g Top Notch Terrace
  - h Galleria
  - i Usdan Gallery
  - j Kinoteca
- 11 Center for the Advancement of Public Action (CAPA)
- 12 Campus Safety
- 13 East Academic Center (EAC)

### Community Life

- 14 Commons/Dining Halls
- 15 Student Center/Café/Game Room
- 16 Tennis and Basketball Courts/Soccer Field
- 17 Meyer Recreation Barn
- 18 Helen Frankenthaler '49 Secret Garden

### Faculty/Alumni Housing

- 19 Davis Alumni House
- 20 Faculty Houses (Faculty Row f1, f2, f3, f4)  
(Orchard a, b, c, d, e, f)
- 21 Shingle Cottage

### Student Houses

- |               |                 |
|---------------|-----------------|
| 22 Longmeadow | 32 Bingham      |
| 23 Swan       | 33 McCullough   |
| 24 Woolley    | 34 Leigh        |
| 25 Stokes     | 35 Fels         |
| 26 Franklin   | 36 Sawtell      |
| 27 Canfield   | 37 Noyes        |
| 28 Dewey      | 38 Perkins      |
| 29 Booth      | 39 Merck        |
| 30 Kilpatrick | 40 Paris-Borden |
| 31 Welling    |                 |